

ALL DRILLED BOLTS
TO BE SAFETY WIRED

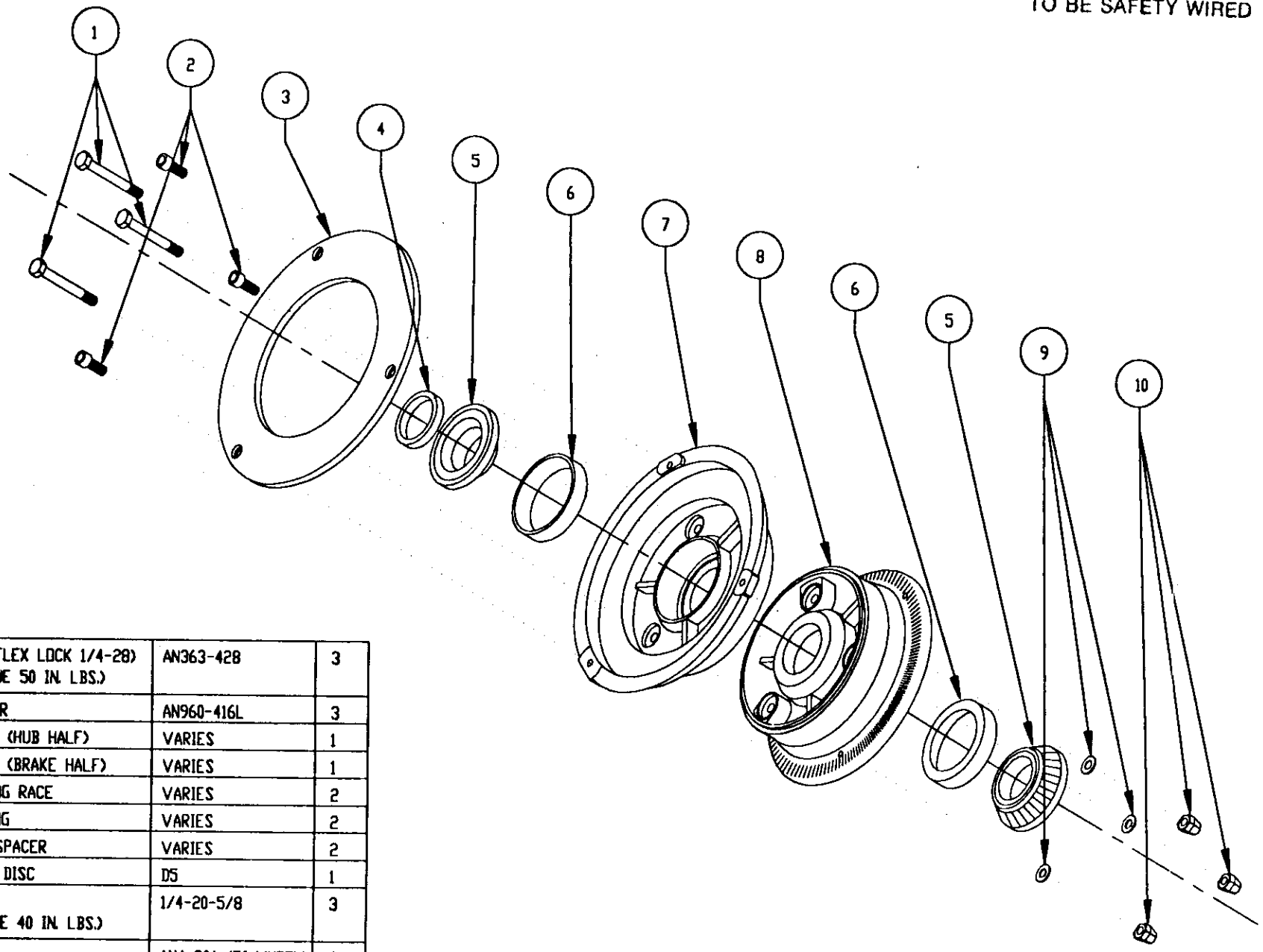

10	NUT (FLEX LOCK 1/4-20) (TORQUE 50 IN. LBS.)	AN363-42B	3
9	WASHER	AN960-416L	3
8	WHEEL (HUB HALF)	VARIES	1
7	WHEEL (BRAKE HALF)	VARIES	1
6	BEARING RACE	VARIES	2
5	BEARING	VARIES	2
4	AXLE SPACER	VARIES	2
3	BRAKE DISC	DS	1
2	SHCS (TORQUE 40 IN. LBS.)	1/4-20-5/8	3
1	BOLT	AN4-20A (5" WHEEL) AN4-16A (6" WHEEL)	3
NCL	PART NAME	INVENTORY NO.	REQ'D

3D-WHEEL
 MATCO mfg
 65 East Kensington Ave
 SALT LAKE CITY, UT 84115 (801) 486-7574

WHEEL ASSEMBLY

DRAWN BY: GARY P. LANGFORD
 CHECKED BY:

SCALE: NONE
 DATE: NOV. 29, 1990

1 OF 1